

VISUAL LANDPRO 101

2010 CLASS REGISTRATION FORM

FAX to 1-281-292-9737 or email salesinfo@landpro.com

Confirmation #: _____ (we fill this in and email back to you...)

CLASS: **VLP101** **INTRO TO VISUAL LANDPRO 2000 (*)**

DATE: (check one) [] JUNE 24-25, 2010 (2-Day Class) 9AM-5PM
[] SEPT 13-14, 2010 (**) (2-Day Class) 9AM-5PM
[] NOV 15-16, 2010 (**) (2-Day Class) 9AM-5PM
[] **EARLIER** classes may become available. Check this if interested.

PLACE: LANDPRO CORP TRAINING FACILITY 2-DAY CLASS: \$1,250
21755 IH-45 NORTH, BDG 7
SPRING, TX 77388
PH: (281) 363-4213

(*) CREDITS: This program has been accredited for 12 RL/RPL/CPL continuing education credits, which includes 0 CPL/ESA recertification credit(s) and 0 Ethics credit(s), for a total of 6 RL/RPL/CPL credits per day

COMPANY NAME / ATTENTION TO:	
COMPANY ADDRESS	
COMPANY PHONE	
COMPANY FAX	

STUDENT NAME	CELLULAR #	EMAIL	Experience (YEARS)

(**) Note: September and November Dates may change. Always book flights REFUNDABLE in case of any last-minute changes.

DIRECTIONS TO LANDPRO CORP ON NEXT PAGE

DIRECTIONS FROM HOUSTON

We are approximately 20 miles NORTH of Downtown Houston. Just NORTH of FM-2920, on the SOUTH-BOUND side of I-45

Go NORTH on I-45

Exit 70-B (Spring-Stuebner WEST)

Take Spring-Stuebner WEST, but then MAKE an immediate U-TURN and stay on I-45 FEEDER going SOUTH-BOUND

Immediate RIGHT at 21755 IH-45 (see the large LUMBER LIQUIDATORS YELLOW sign)

Proceed to BLDG 7 – LANDPRO CORP

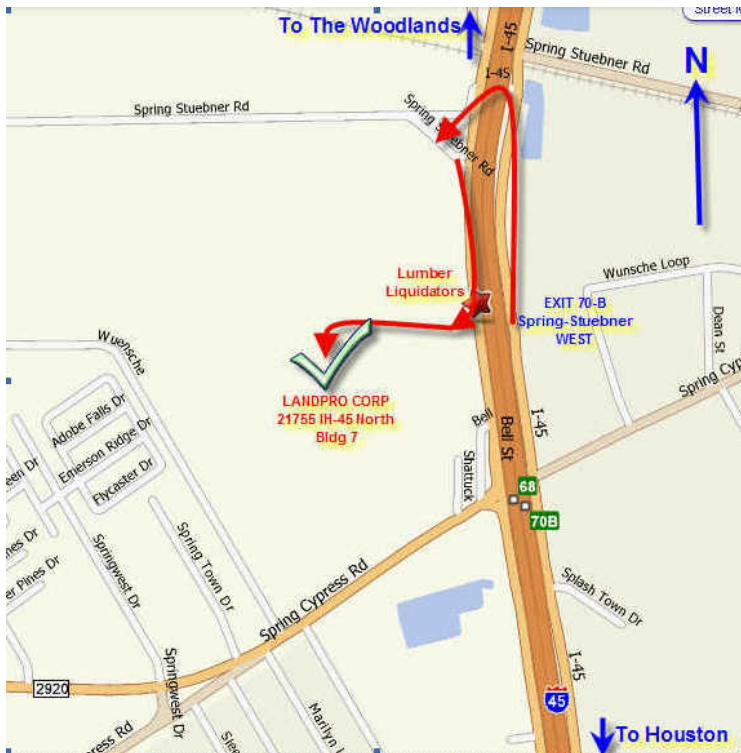

LandPro Corp * 21755 IH-45 N, Bldg 7 * Spring, TX 77388 (281) 363-4213